

\$1,250,000 - 1720 Fenton Street, Lakewood

MLS® #4156416 Listing Office: Your Castle Real Estate Inc

\$1,250,000

0 Bedroom, 0.00 Bathroom,
Land on 0 Acres

Edgewater Annex, Lakewood, CO

The site is currently in the process of being entitled for twelve LEED Gold Townhomes. Seller will provide buyer with architectural plans, surveys, soil and environmental reports and all documentation as it relates to the proposed development once under contract. Seller will provide an itemized list of all soft costs accrued up to this point. Seller is approximately 85% to 90% through the entitlement/development process.

RECOLORADO



Listing Courtesy of Your Castle Real Estate Inc

Essential Information

MLS® #	4156416
Price	\$1,250,000
Bathrooms	0.00
Acres	0.46
Type	Land
Sub-Type	Improved Land
Status	Active

Community Information

Address	1720 Fenton Street
Subdivision	Edgewater Annex
City	Lakewood
County	Jefferson
State	CO
Zip Code	80214

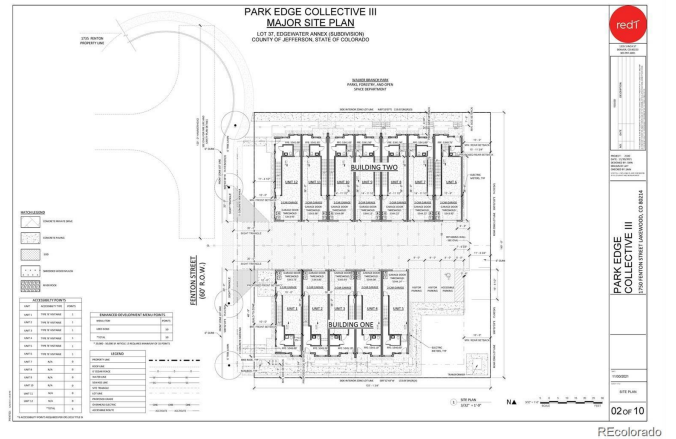

REcolorado

Amenities

Utilities	Cable Available, Electricity Available, Electricity Connected, Natural Gas Available, Sewer Connected
View	City, Lake, Mountain(s)

Exterior

Lot Description	Cul-De-Sac
-----------------	------------

School Information

District	Jefferson County R-1
----------	----------------------

Additional Information

Date Listed	May 31st, 2023
Zoning	R-MF

RECOLORADO®

Terms and Conditions: The content relating to real estate for sale in this Web site comes in part from the Internet Data eXchange ("IDX") program of METROLIST, INC., DBA RECOLORADO® Real estate listings held by brokers other than RE/MAX Professionals are marked with the IDX Logo. This information is being provided for the consumers personal, non-commercial use and may not be used for any other purpose. All information subject to change and should be independently verified.

Copyright 2025 METROLIST, INC., DBA RECOLORADO® -- All Rights Reserved 6455 S. Yosemite St., Suite 500 Greenwood Village, CO 80111 USA

Listing information last updated on July 16th, 2025 at 10:18pm MDT